

Carlingford II



2127 sq. ft.

Main Floor: 1000 sq. ft.
Upper Floor: 1127 sq. ft.

- 2 storey, 2127 sq. ft.
- 3 bedrooms, 2 baths
- Large kitchen with walk through pantry
- Upper floor laundry room
- Spacious Lifestyle room
- Master suite with a walk in closet and 5-piece ensuite featuring his and her sinks, soaker tub, and seperate shower.



Front Elevation

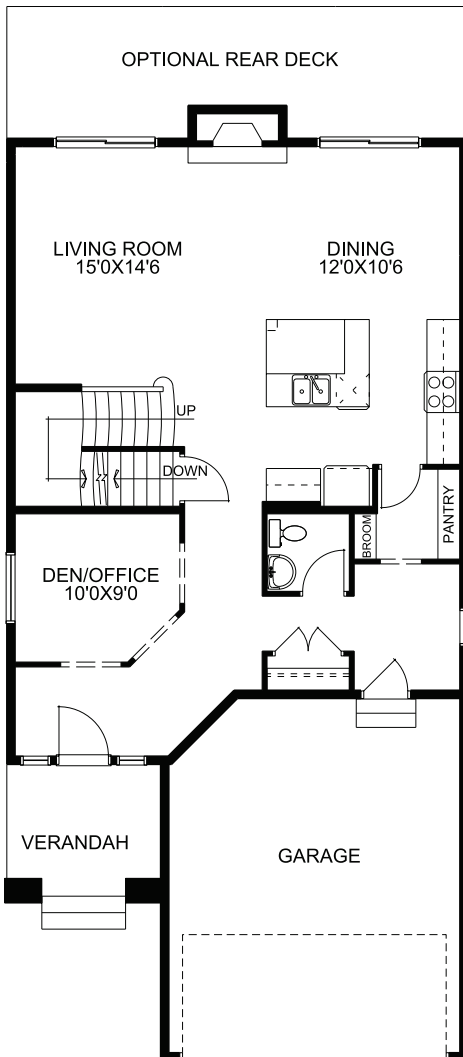

Main Floor

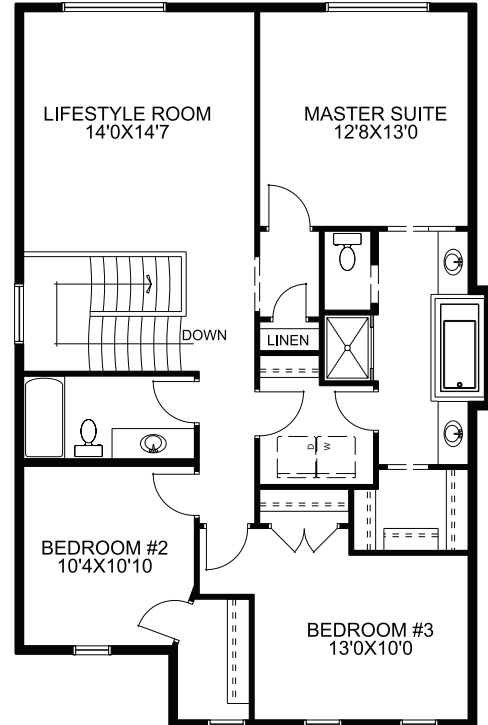

Upper Floor



McKEE HOMES

Your family home. Our family business.

403-948-6595 • mckeehomes.com

*Plans subject to change. Please consult your sales person for details.